

# SPOCAL E53 - SPOCAL E62 LL EXTERNAL PROJECTION FRAMES

## LATERAL LEVER - TECHNICAL DETAILS

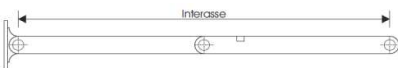

Arms length: 530/380 mm



Guide 22x53 mm

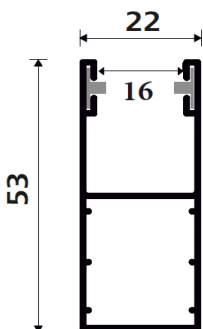

Guide 27x62 mm

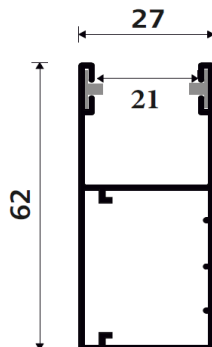

### SPOCAL E53 - SPOCAL E62 LATERAL LEVER FEATURES

The SPOCAL E53 and SPOCAL E62 Lateral Lever projection frames, packed in the desired sizes, are composed of:

- **Aluminum guide (measures 22x53 mm or 27x62 mm)** with rubber seals or brush seals, plastic entry and holes for installation.
- **Aluminum crossbar (measures 18x32 mm).**
- **Aluminum arms (length: 530 mm).**
- **Aluminum hinges.**
- **Nylon inner stoppers.**
- **Stainless steel screws for installation and plastic plug.**

This is recommended for opening widths up to a maximum of 1400 mm.

**SPOCAL E53:** Suitable for rolling shutters from 8 mm to 15 mm of slat thickness.

**SPOCAL E62:** Suitable for rolling shutters from 12 mm to 14 mm of slat thickness.

### OPTIONALS

- **Easy line:** Modification to the hinges to allow the rolling shutter movement even when the projection frame is opened outwards.
- **Arms of 380 mm in length.**
- **Painted arms.** Available in these colours: White RAL 9010, Ivory RAL 1013, Green RAL 6005, Brown RAL 8017. Other colours available upon request.
- **Aluminum ROLLING SHUTTER BOX.**

### HOW TO ORDER:

- Provide window opening measurements: **Opening Width (L) X Opening Height (H).**
- **Specify the slat thickness.**
- **Specify projection frame colours and any optionals.**

( If installed in the window frame, indicate rolling shutter box height )

### SPOCAL E53 - SPOCAL E62 LL COLOUR MATCHING

Guides and Crossbars	Arms STANDARD	Aluminum hinges
Silver Anodized	Silver Anodized	Silver Anodized
Bronze Anodized	Bronze Anodized	Bronze Anodized
Black RAL 9005	Black Anodized	Black RAL 9005
White RAL 9010 - Ivory RAL 1013	Silver Anodized	White RAL 9010 - Ivory RAL 1013
Green RAL 6005 - Brown RAL 8017	Black Anodized	Green RAL 6005 - Brown RAL 8017
<i>RAL on request</i>	<i>Anodized</i>	<i>RAL on request</i>

# SPOCAL E53 - SPOCAL E62 INSTALLED OUTSIDE ON THE WALL

## LATERAL LEVER - TECHNICAL DETAILS

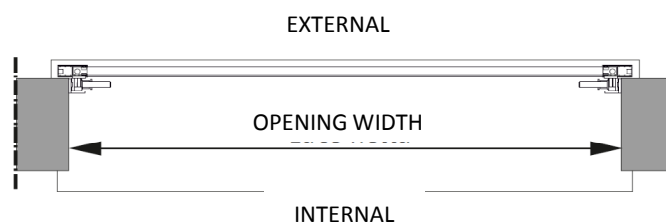
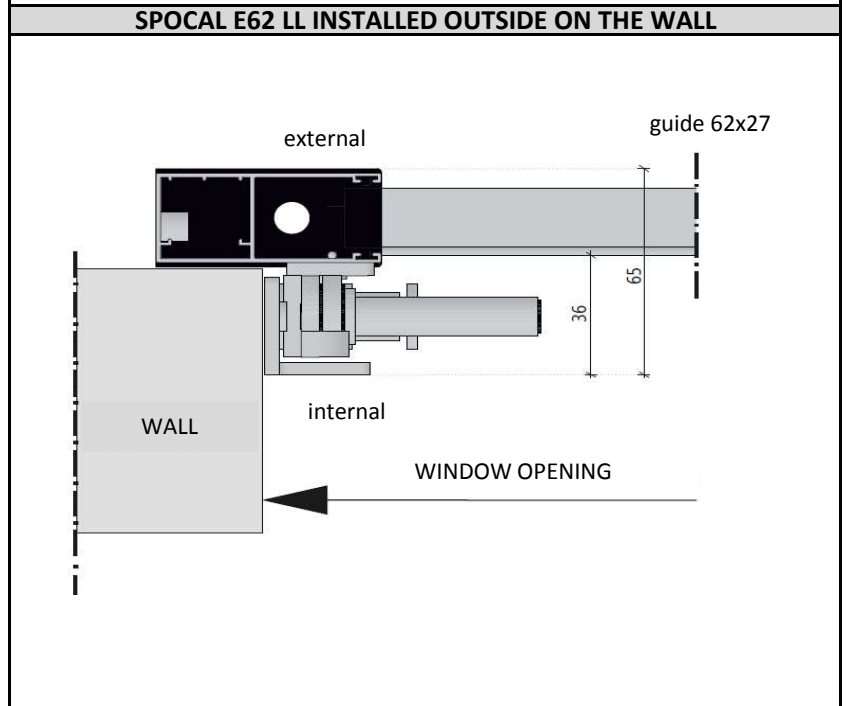
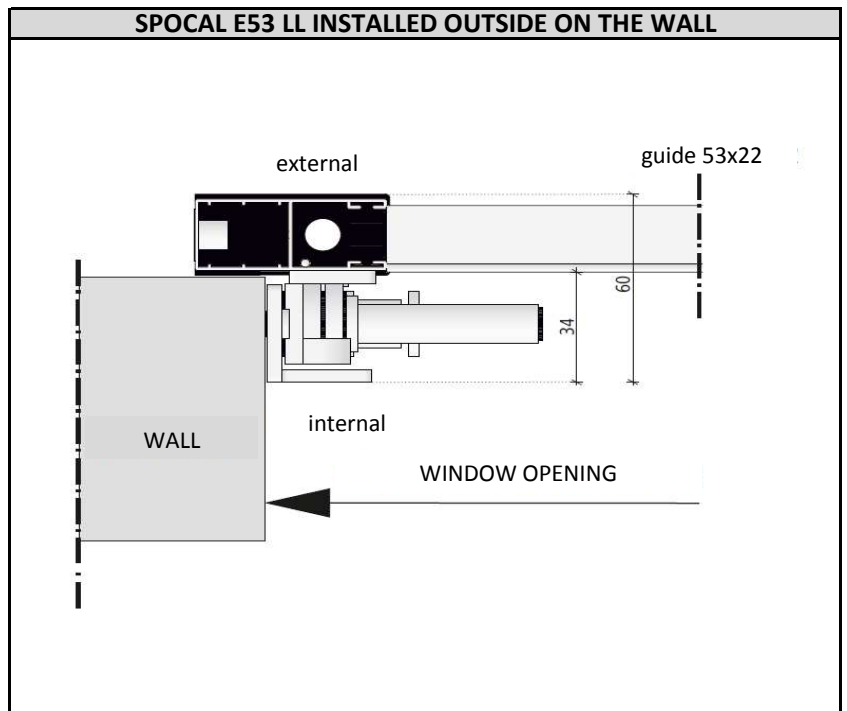
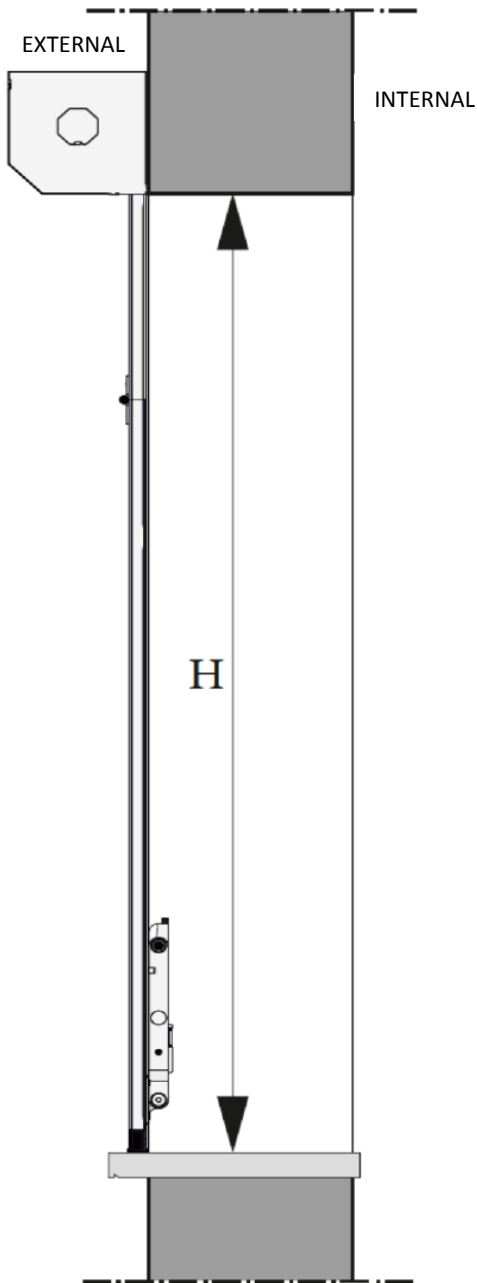

# SPOCAL E53 - SPOCAL E62 INSTALLED OUTSIDE IN THE WINDOW FRAME

## LATERAL LEVER - TECHNICAL DETAILS

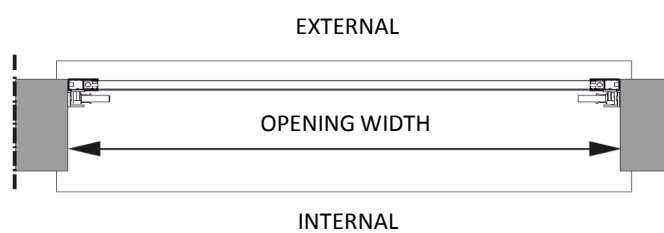
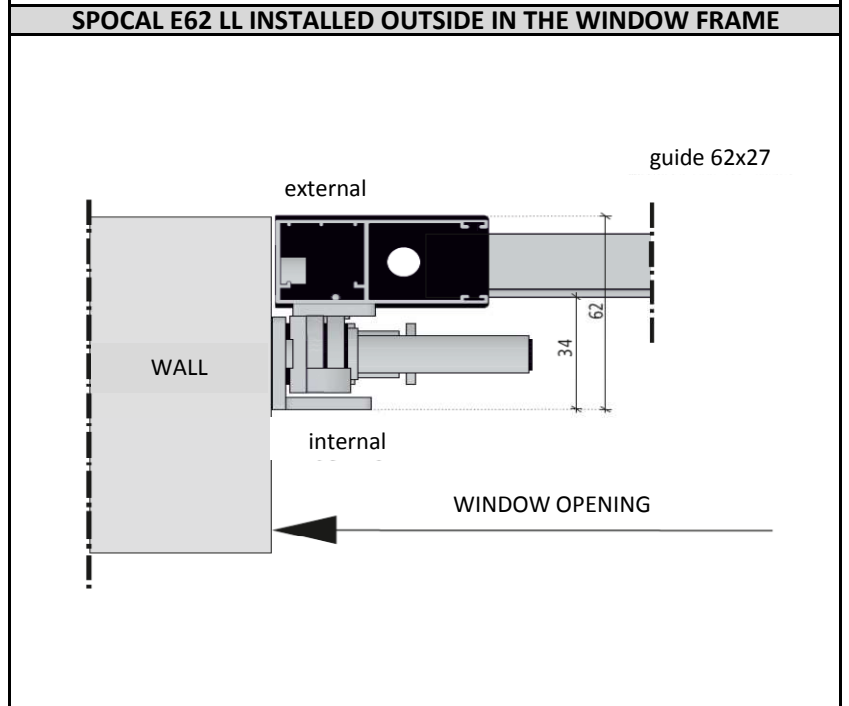
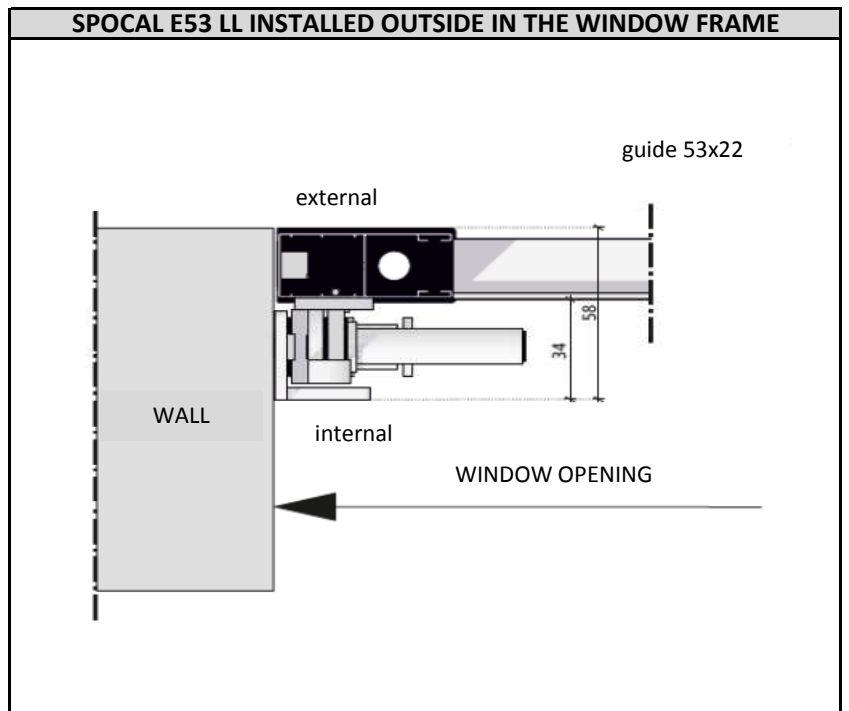
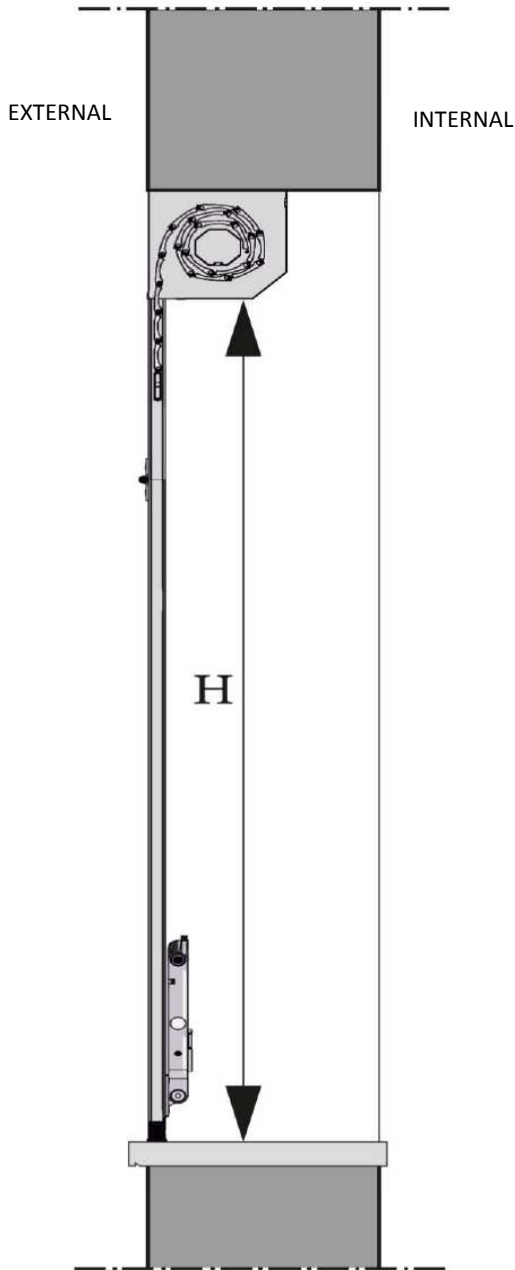

# SPOCAL E53 - SPOCAL E62 EXTERNAL PROJECTION FRAMES

## CENTRAL LEVER - TECHNICAL DETAILS

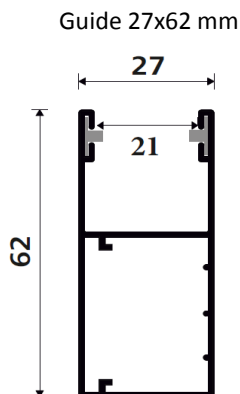
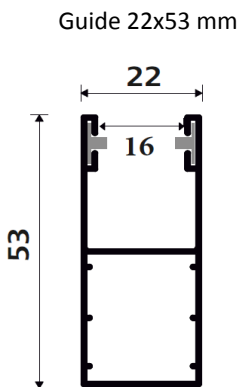
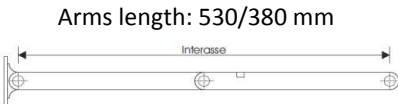

### SPOCAL E53 - SPOCAL E62 CENTRAL LEVER FEATURES

The SPOCAL E53 and SPOCAL E62 Lateral Lever projection frames, packed in the desired sizes, are composed of:

- **Aluminum guide (measures 22x53 mm or 27x62 mm)** with rubber seals or brush seals , plastic entry and holes for installation.
- **Aluminum crossbar (measures 18x32 mm).**
- **Aluminum arms (length: 530 mm).**
- **Aluminum rod and handle** in the same colour as arms.
- **Aluminum hinges.**
- **Nylon inner stoppers.**
- **Stainless steel screws for installation** and **plastic plug.**
- **Nylon rest arms LC.**

This is recommended for windows over 1400 mm in width and up to a maximum of 3000 mm in width.

A double handle and a reinforcement inside the crossbar are installed on the frame for rolling shutters from 2300 mm to 3000 mm wide, unless otherwise specified.

**SPOCAL E53:** Suitable for rolling shutters from 8 mm to 15 mm of slat thickness.

**SPOCAL E62:** Suitable for rolling shutters from 12 mm to 14 mm of slat thickness.

### OPTIONALS

- **Easy line:** Modification to the hinges to allow the rolling shutter movement even when the projection frame is opened outwards.
- **Arms of 380 mm in length.**
- **Painted arms, rod and handle.** Available in these colours: White RAL 9010, Ivory RAL 1013, Green RAL 6005, Brown RAL 8017. Other colours available upon request.
- **Aluminum ROLLING SHUTTER BOX.**

### HOW TO ORDER:

- Provide the opening window measurements: **Opening Width (L) X Opening Height (H).**
- **Specify the slat thickness.**
- **Specify projection frames colours and any optional.**

( If installed in the window frame, indicate rolling shutter box height )

### SPOCAL E53 - SPOCAL E62 LL COLOUR MATCHING

Guides and Crossbars	Arms, rod and handle STANDARD	Aluminum hinges
Silver Anodized	Silver Anodized	Silver Anodized
Bronze Anodized	Bronze Anodized	Bronze Anodized
Black RAL 9005	Black Anodized	Black RAL 9005
White RAL 9010 - Ivory RAL 1013	Silver Anodized	White RAL 9010 - Ivory RAL 1013
Green RAL 6005 - Brown RAL 8017	Black Anodized	Green RAL 6005 - Brown RAL 8017
<i>RAL on request</i>	<i>Anodized</i>	<i>RAL on request</i>

# SPOCAL E53 - SPOCAL E62 INSTALLED OUTSIDE ON THE WALL

## CENTRAL LEVER - TECHNICAL DETAILS

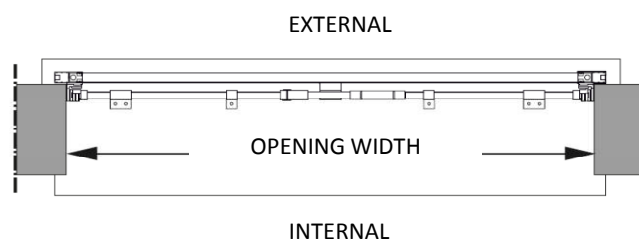
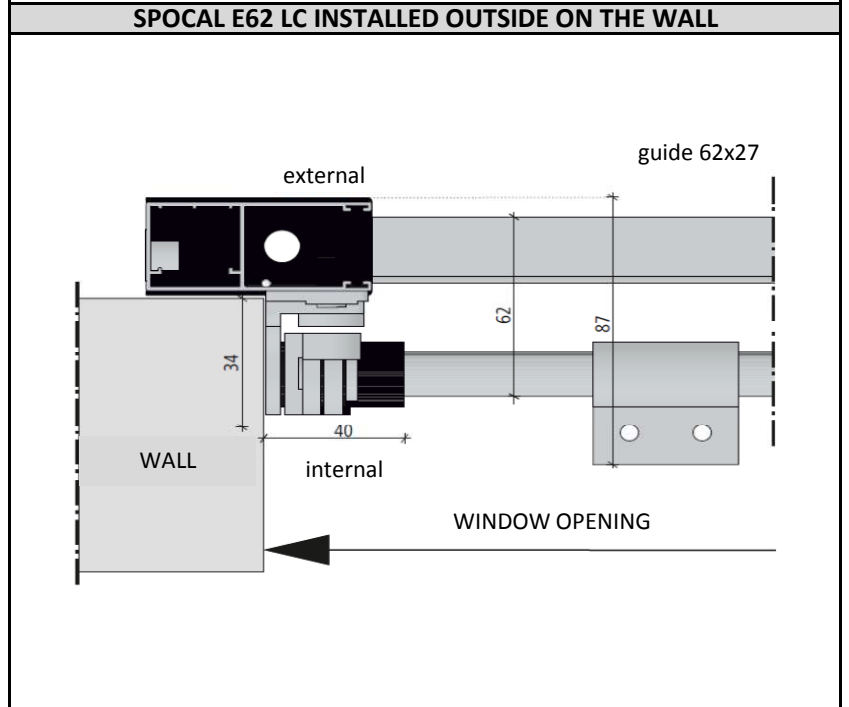
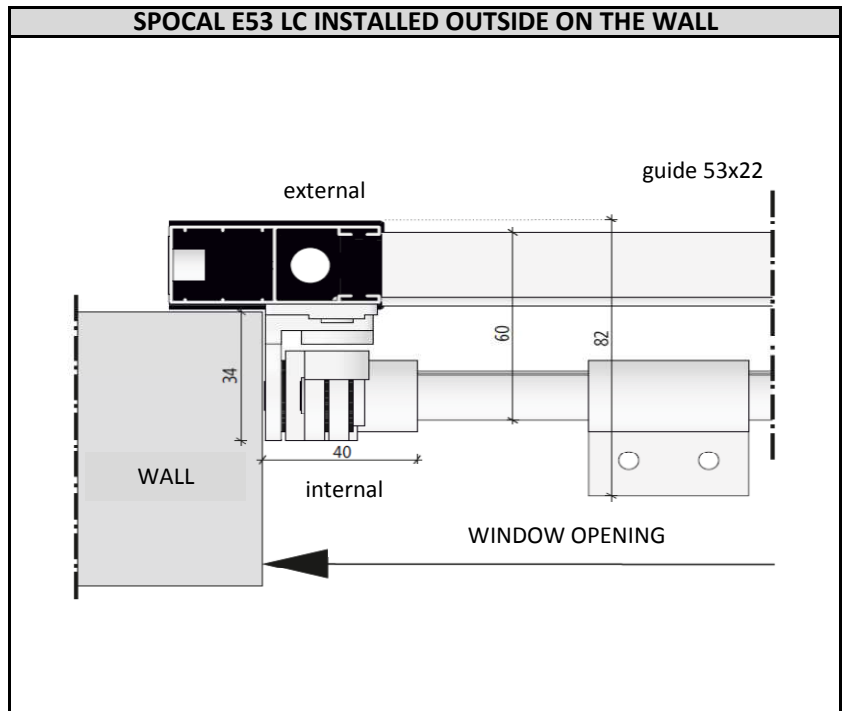
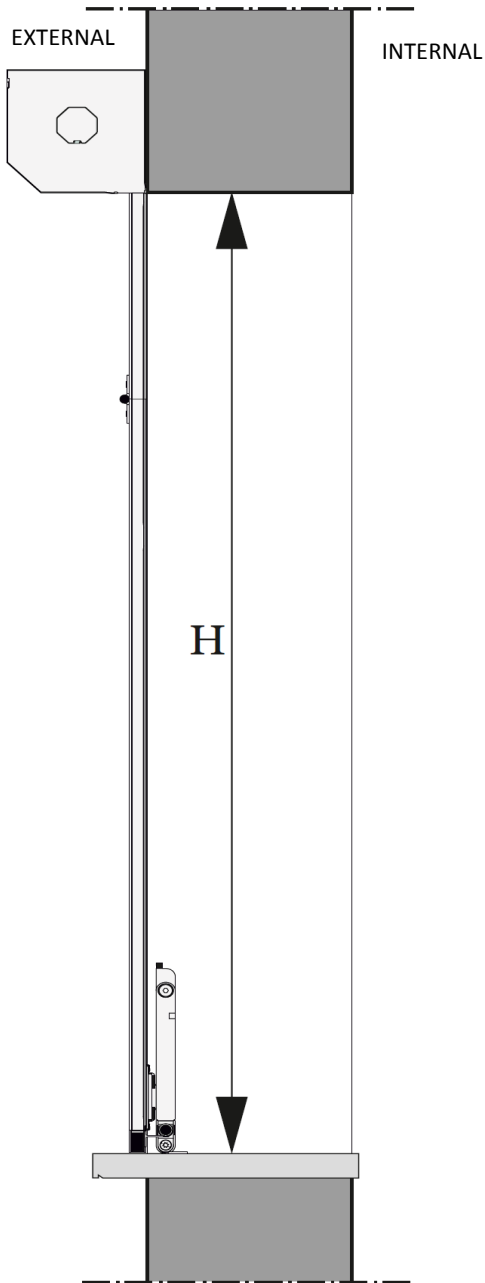

# SPOCAL E53 - SPOCAL E62 INSTALLED OUTSIDE IN THE WINDOW FRAME

## CENTRAL LEVER - TECHNICAL DETAILS

