

**INSTALLATION INSTRUCTIONS CENTRAL LEVER "SPOCAL E53" and "SPOCAL E62" PROJECTION FRAMES
OUTSIDE ON THE WALL**

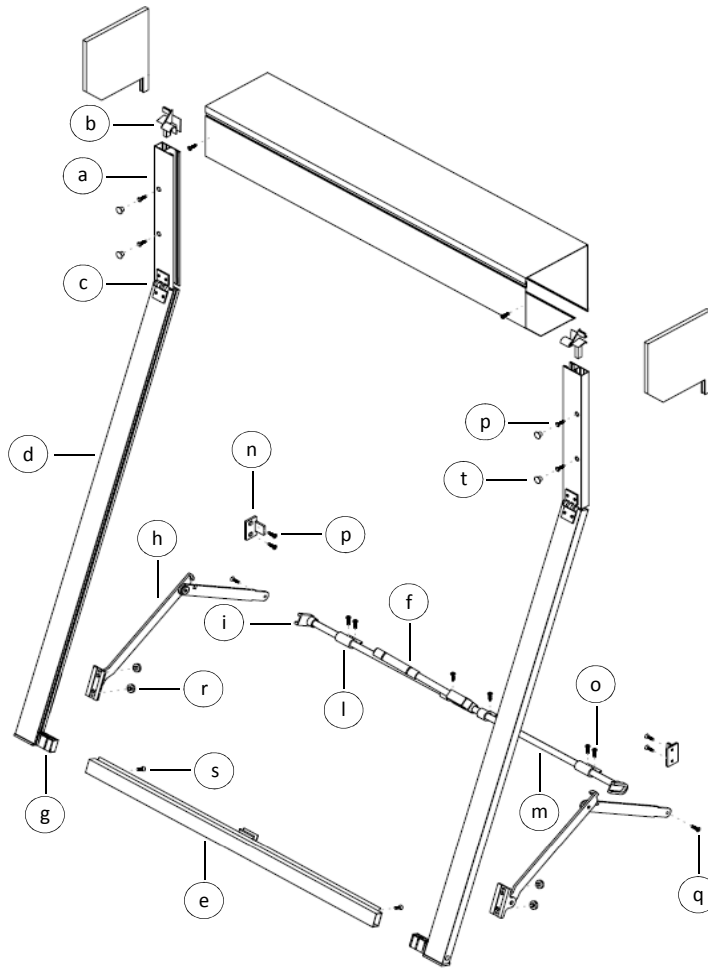

a	Fixed superior guide
b	Plastic entry guide
c	Hinges
d	Mobile guide
e	Crossbar
f	Handle
g	Nylon inner stopper
h	Arms LC
i	Nylon bushing
l	Eyelet
m	Rod
n	Nylon rest arms LC
t	Plastic screw cover cap

SCREW KIT	
o	<p>N°6 Screws 3,9x25 T.C.</p>
p	<p>N°8 Screws 3,9x25 T.G.S.</p>
q	<p>N°2 Screws 5,5x16 T.C.</p>
r	<p>N°4 Aluminum screws</p>
s	<p>N°2 Screws 3,9x13 T.C.</p>

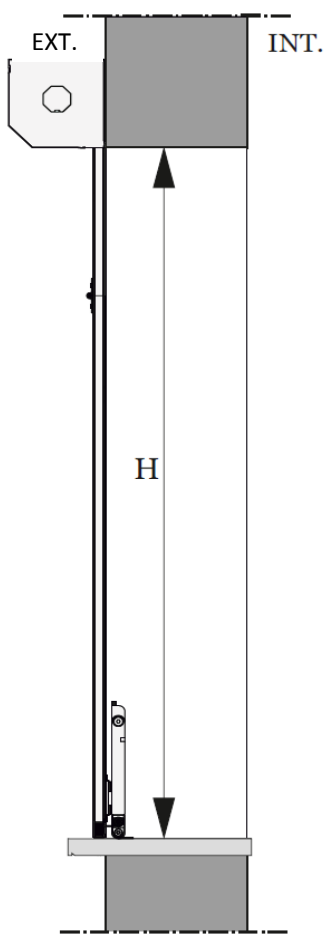
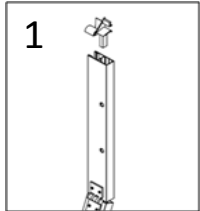

1. Insert the plastic entry guide (b) into the fixed guides (a) and fix them to the roller shutter box already assembled (we suggest to install the roller shutter and accessories after fixing the box to the wall).

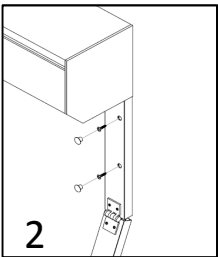

2. Fix the shutter box to the window external façade and the guides (a) using the screws 3.9x25 T.G.S (p).

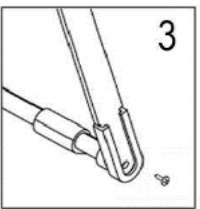

3. Insert the arms (h) into the nylon bushings (i) and fix them to the rod with 5.5x16 T.C. (q) screws.

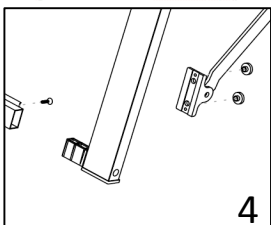

4. Join the crossbar (e) to the guides (d) through the nylon inner stoppers (g) and fix them with 3.9x13 T.C. (s) screws.

Fix the arm (h) to the mobile guides (d) using the aluminum screws (r).

5. Fix the eyelets (l) on the window sill with the screws 3.9x25 T.C. (o).

6. Install the nylon rest (n) on the wall where the arms lean when in closed position. Use the screws 3.9x25 T.G.S. (p).

